

D=27 mm U8/U9/U9XE Inlay/Label

Inlay includes dry Inlay and wet Inlay. Dry Inlay does not contain backglue, its structure is antenna + chip + substrate (generally PET). Wet Inlay contains glue and its structure is antenna + chip + substrate (generally PET) + adhesive + release paper, such as no printing and other requirements, can be used directly. Label has one more surface layer on top of wet Inlay, the surface material could be coated paper, PET or fragile paper, etc. The label dimension will be customizable meet different requirements. The Inlay/Label conforms to EPC C1G2 (ISO18000-6C) standard and operates at 860~960MHz, mainly used in logistics, retail, asset management, baggage management, etc.

Physical Features:

Antenna Size:	D=27 mm
Wet Inlay/Label Size:	D=30 mm(customized)
Label Material:	Coated Paper/PET/Fragile Paper
Working Temp:	-40~+85°C
Storage Temp:	23 ± 3°C
Storage Humidity:	50 ± 15%RH

RFID Features:

RFID Standard:	ISO/IEC 18000-6C (EPC Gen2)
Chip Type:	NXP UCode 8/9/9XE
Memory(U8):	User - N/A; EPC - 128 bits; TID - 96 bits; Access Passwords - 32 bits
Memory(U9):	User - N/A; EPC - 96 bits; TID - 96 bits; Access Passwords - N/A
Memory(U9XE):	User - N/A; EPC - 128 bits; TID - 96 bits; Access Passwords - N/A
Read Range(Fixed Reader):	6.0 m

Other Features:

Data Storage:	> 10 years
Re-write:	100,000 times
Customization:	Logo, barcode/QR code, number printing, encoding, design, etc.
Package:	Reel core inner dimension: 76.2mm / 3(in), Outside diameter < 220 mm / 8.7(in), 1000-5000pcs/roll, 4 rolls /carton
Application:	<ul style="list-style-type: none"> ● Packing management ● Logistics management ● Document management ● Assets management, etc.

Dimensions:

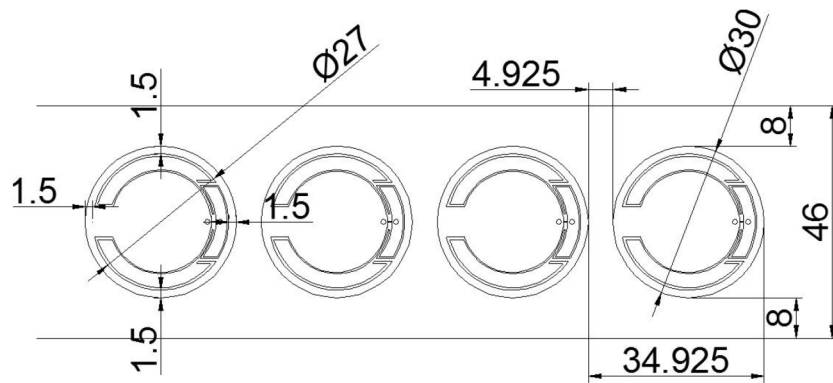

Read Range:

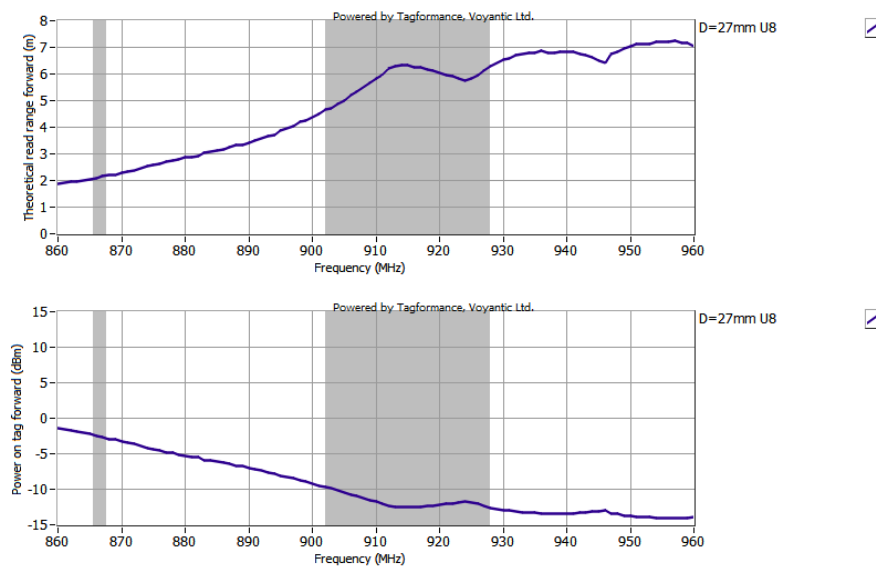

Application:

